



# TECHNICAL INFORMATION

---

## **HOTEL SERIES**

## B20 "DND & MUR" SWITCH

### FEATURES :

The "Do Not Disturb" & "Make Up Room" indicators are using Built-in LED indicator which provides longer lifespan with less power.

#### B21BPD

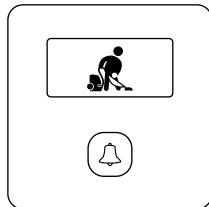

Bell Push Switch with  
"Do Not Disturb" Indicator.

#### SPECIFICATIONS

Voltage : 220 VAC, 50/60 Hz  
Dimension : 80 x 80 mm  
Mounting Centre : 60,3 mm

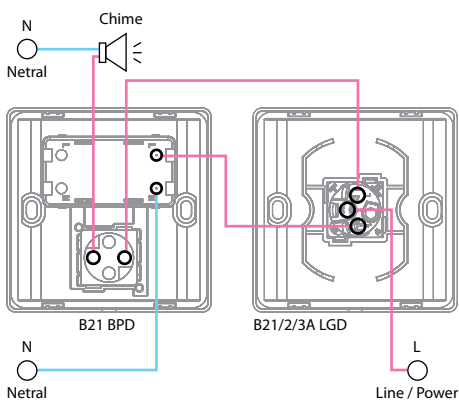

#### B21BPDM



Bell Push Switch with  
"Do Not Disturb" &  
"Make Up Room" Indicator.

#### SPECIFICATIONS

Voltage : 220 VAC, 50/60 Hz  
Dimension : 80 x 80 mm  
Mounting Centre : 60,3 mm

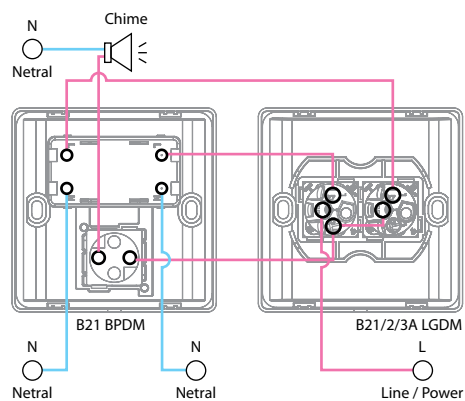

### MOUNTING INSTRUCTION

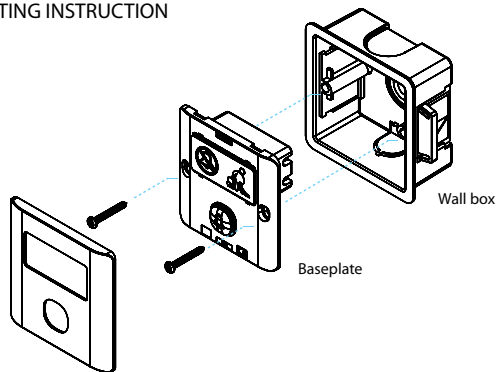

1. Align and place the baseplate on the wall box and then fasten the screw on both sides.

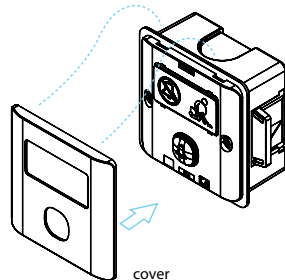

2. To install the cover, align cover locking clip onto the baseplate and press firmly on the cover until you hear a clear "click" sound.

### REMOVING THE COVER



To remove the cover :

1. Insert a screwdriver between the cover and the wall surface carefully, then twist the screwdriver to dislodge the cover from the baseplate.
2. Use the other hand to support and remove the cover.

**ATTENTION :**  
Electrical installation must be  
carried out by a qualified electrician.

# B1000 "DND & MUR" SWITCH

## FEATURES :

The "Do Not Disturb" & "Make Up Room" indicators are using Built-in LED indicator which provides longer lifespan with less power.

### B1031BPD

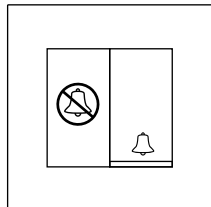

Bell Push Switch with  
"Do Not Disturb" Indicator.

#### SPECIFICATIONS

Voltage : 220 VAC, 50/60 Hz  
Dimension : 86 x 86 mm  
Mounting Centre : 60,3 mm

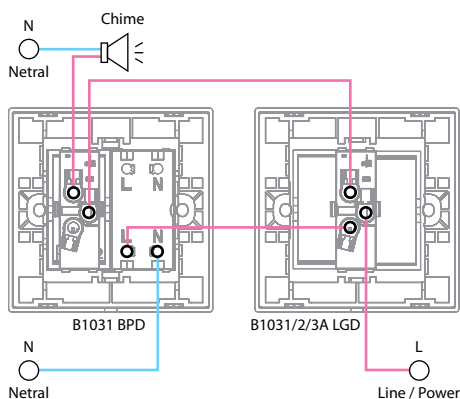

### B1031BPDM



Bell Push Switch with  
"Do Not Disturb" &  
"Make Up Room" Indicator.

#### SPECIFICATIONS

Voltage : 220 VAC, 50/60 Hz  
Dimension : 86 x 86 mm  
Mounting Centre : 60,3 mm

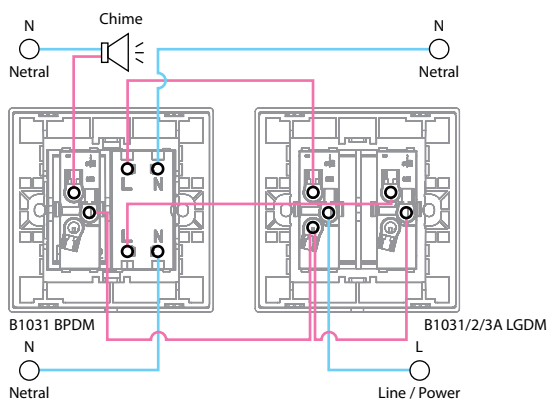

## MOUNTING INSTRUCTION

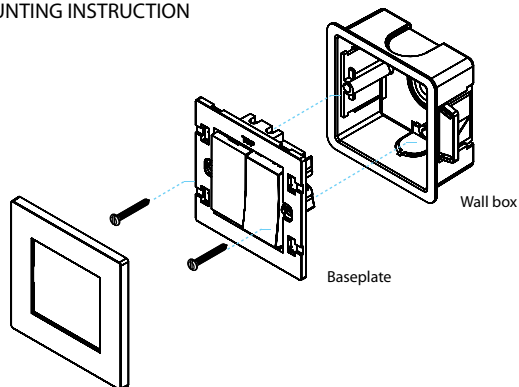

1. Align and place the baseplate on the wall box and then fasten the screw on both sides.

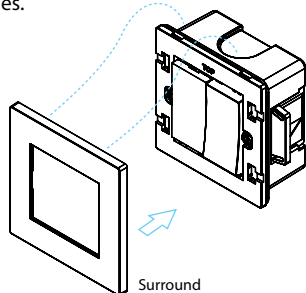

2. To install the surround, align surround locking clip onto the baseplate and press firmly on the surround until you hear a clear "click" sound.

## REMOVING THE COVER



To remove the cover :

1. Insert a screwdriver between the surround and the wall surface carefully, then twist the screwdriver to dislodge the surround from the baseplate.
2. Use the other hand to support and remove the surround.

**ATTENTION :**  
Electrical installation must be carried out by a qualified electrician.

# B2000L "DND & MUR" SWITCH

## FEATURES :

The "Do Not Disturb" & "Make Up Room" indicators are using Built-in LED indicator which provides longer lifespan with less power.

### B2031L BPD

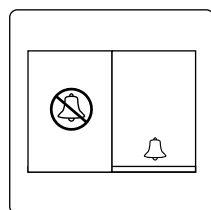

Bell Push Switch with  
"Do Not Disturb" Indicator.

#### SPECIFICATIONS

Voltage : 220 VAC, 50/60 Hz  
Dimension : 87 x 87 mm  
Mounting Centre : 60,3 mm

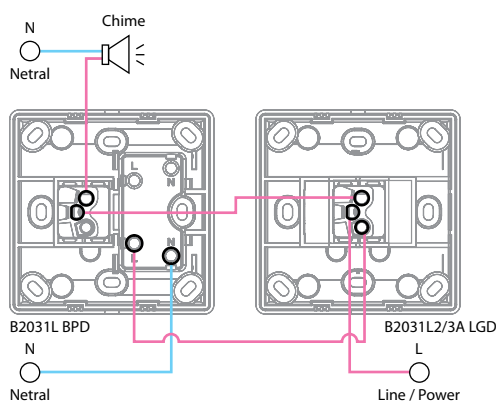

### B2031L BPDM

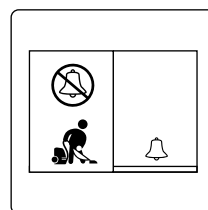

Bell Push Switch with  
"Do Not Disturb" &  
"Make Up Room" Indicator.

#### SPECIFICATIONS

Voltage : 220 VAC, 50/60 Hz  
Dimension : 87 x 87 mm  
Mounting Centre : 60,3 mm

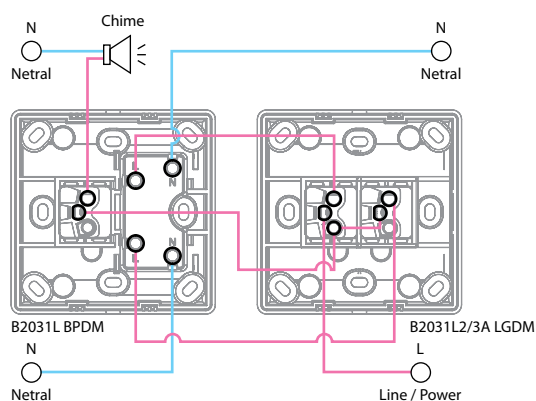

## MOUNTING INSTRUCTION

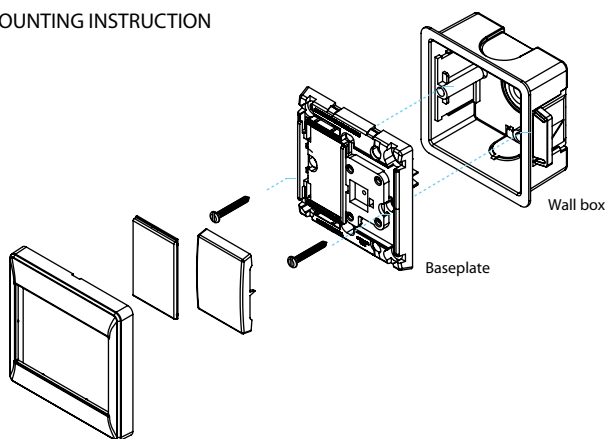

1. Align and place the baseplate on the wall box and then fasten the screw on both sides.

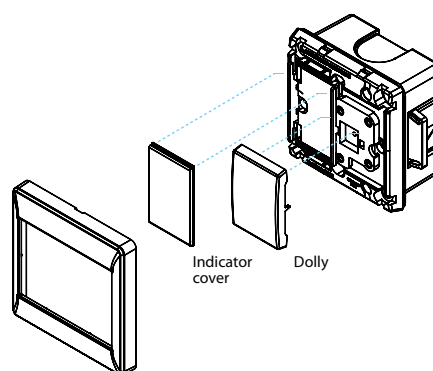

2. To install dolly and indicator cover, align dolly locking pin onto dolly base and press firmly the dolly. Align indicator cover locking pin onto indicator locking part and press firmly the indicator cover.

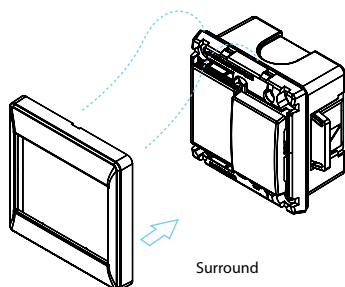

3. To install the surround, align surround locking clip onto the baseplate and press firmly on the surround until you hear a clear "click" sound.

**ATTENTION :**  
Electrical installation must be  
carried out by a qualified electrician.

# REMOVING DOLLY & INDICATOR COVER

**ATTENTION :**  
Electrical installation must be  
carried out by a qualified electrician.

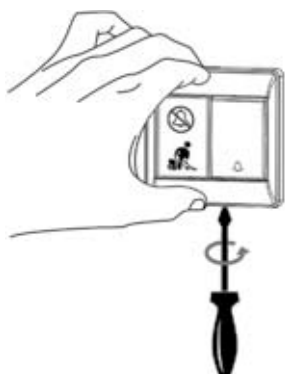

To remove the cover :

1. Insert a screwdriver between the surround and the wall surface carefully, then twist the screwdriver to dislodge the surround from the baseplate.
2. Use the other hand to support and remove the surround.



To remove the dolly :

1. Insert a screwdriver between the dolly and the baseplate carefully, then pry it using the screwdriver to dislodge the dolly from the locking area.
2. Use the other hand to support and remove the dolly.



To remove the indicator cover :

1. Insert a screwdriver between the indicator cover and the baseplate carefully, then pry the screwdriver to dislodge the dolly from the locking area.
2. Use the other hand to support and remove the indicator cover.

## B3000 "DND & MUR" INDICATOR

### FEATURES :

The "Do Not Disturb" & "Make Up Room" indicators are using Built-in LED indicator which provides longer lifespan with less power.

#### B3030 VDM



"Do Not Disturb" &  
"Make Up Room" Indicator.

#### SPECIFICATIONS

Voltage : 220 VAC, 50/60 Hz  
Dimension : 87 x 87 mm  
Mounting Centre : 60,3 mm

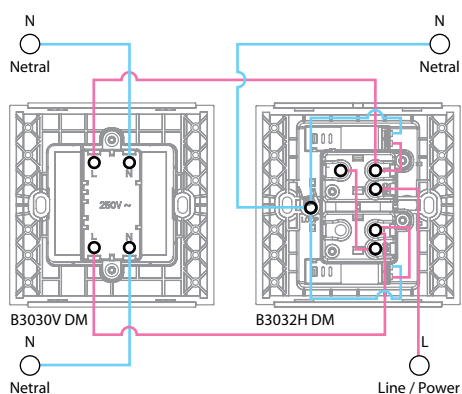

#### B3031V BPDM



Bell Push Switch with  
"Do Not Disturb" &  
"Make Up Room" Indicator.

#### SPECIFICATIONS

Voltage : 220 VAC, 50/60 Hz  
Dimension : 87 x 87 mm  
Mounting Centre : 60,3 mm

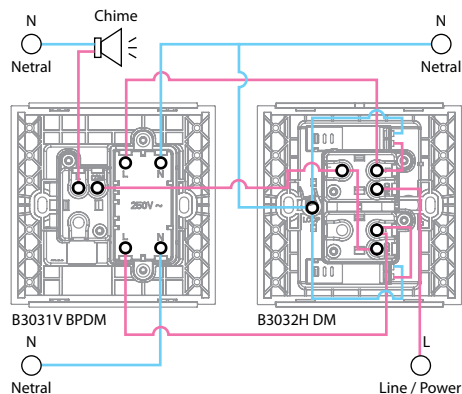

#### B3031V BPD

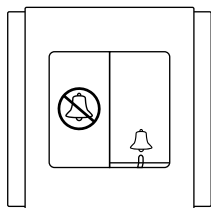

Bell Push Switch with  
"Do Not Disturb" Indicator.

#### SPECIFICATIONS

Voltage : 220 VAC, 50/60 Hz  
Dimension : 87 x 87 mm  
Mounting Centre : 60,3 mm

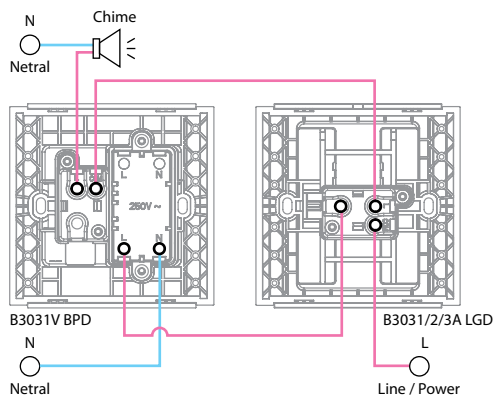

**MOUNTING INSTRUCTION**

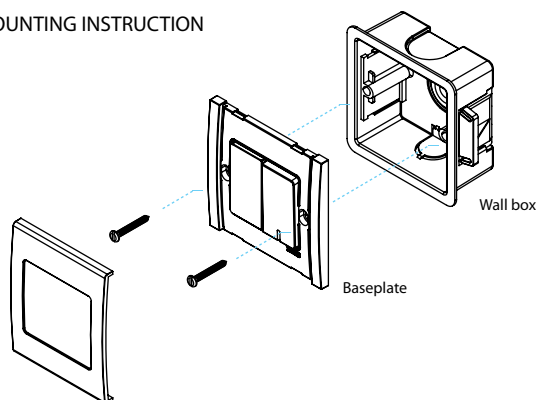

1. Align and place the baseplate on the wall box and then fasten the screw on both sides.

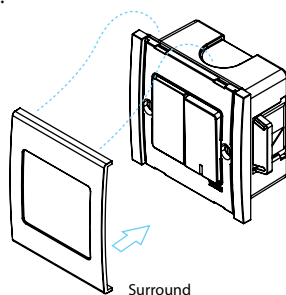

2. To install the surround, align surround locking clip onto the baseplate and press firmly on the surround until you hear a clear "click" sound.

**ATTENTION :**  
Electrical installation must be carried out by a qualified electrician.

**REMOVING THE COVER**

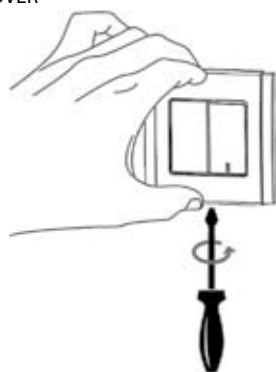

To remove the cover :

1. Insert a screwdriver between the surround and the wall surface carefully, then twist the screwdriver to dislodge the surround from the baseplate.
2. Use the other hand to support and remove the surround.

# B20 KEYCARD SWITCH

## B21EKT

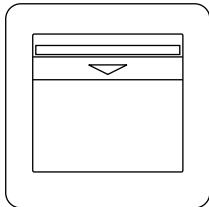

Keycard switch with indicator.

The recommended card size  
W x H x D : 85,5 x 54 x 0,9 mm

Voltage : 220 VAC, 50/60 Hz  
Load Rating : 16 A  
Dimension : 80 x 80 mm  
Mounting Centre : 60,3 mm

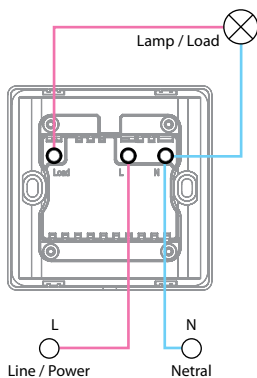

## B21RFKT

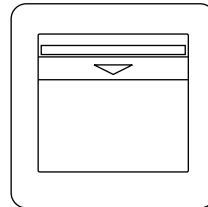

RFID keycard switch with indicator.

The recommended card size  
W x H x D : 85,5 x 54 x 0,9 mm

Voltage : 220 VAC, 50/60 Hz  
Load Rating : 16 A  
Dimension : 80 x 80 mm  
Mounting Centre : 60,3 mm  
RFID Standard : Mifare

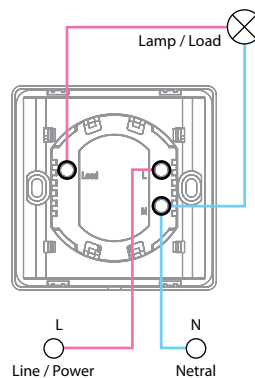

## MOUNTING INSTRUCTION

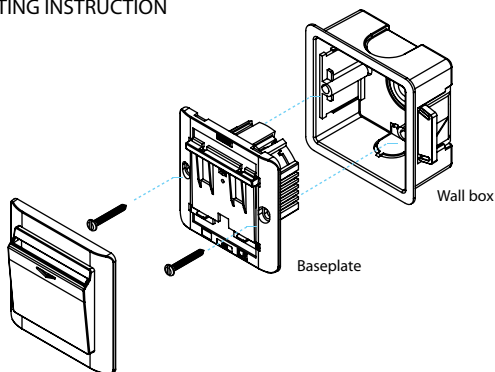

1. Align and place the baseplate on the wall box and then fasten the screw on both sides.

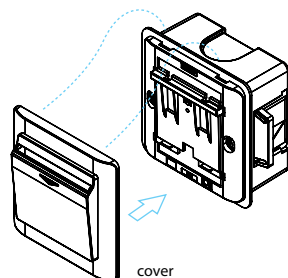

2. To install the cover, align cover locking clip onto the baseplate and press firmly on the cover until you hear a clear "click" sound.

## REMOVING THE COVER



To remove the cover :

1. Insert a screwdriver between the cover and the wall surface carefully, then twist the screwdriver to dislodge the cover from the baseplate.
2. Use the other hand to support and remove the cover.

**ATTENTION :**  
Electrical installation must be carried out by a qualified electrician.



# B1000 KEYCARD SWITCH

## B1031EKT

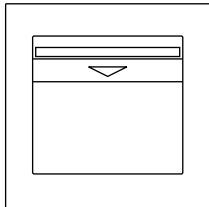

Keycard switch with indicator.

The recommended card size  
W x H x D : 85,5 x 54 x 0,9 mm

Voltage : 220 VAC, 50/60 Hz  
Load Rating : 16 A  
Dimension : 86 x 86 mm  
Mounting Centre : 60,3 mm

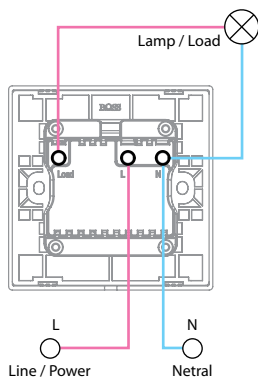

## B1031RFT

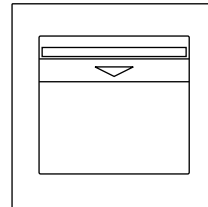

RFID keycard switch with indicator.

The recommended card size  
W x H x D : 85,5 x 54 x 0,9 mm

Voltage : 220 VAC, 50/60 Hz  
Load Rating : 16 A  
Dimension : 86 x 86 mm  
Mounting Centre : 60,3 mm  
RFID Standard : Mifare

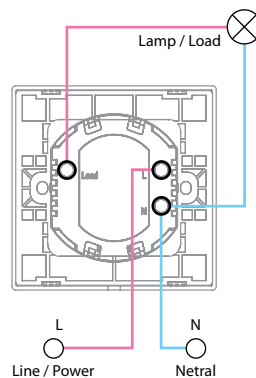

## MOUNTING INSTRUCTION

1. Align and place the baseplate on the wall box and then fasten the screw on both sides.

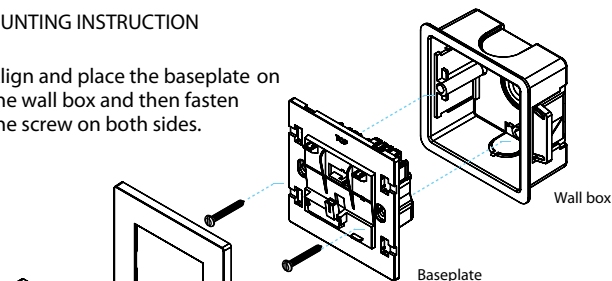

2. To install the surround, align surround locking clip onto the baseplate and press firmly on the surround until you hear a clear "click" sound.

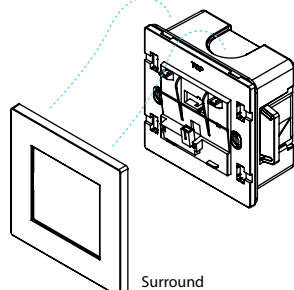

3. Align cover locking clip onto locking area and press firmly the cover until you hear a clear "click" sound.

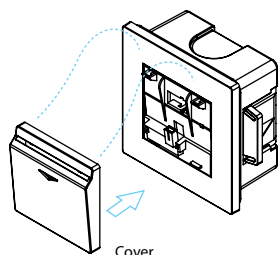

## REMOVING THE COVER

To remove the cover :

1. Insert a screwdriver between the cover and the surround carefully, then twist the screwdriver to dislodge the cover from the locking area.
2. Use the other hand to support and remove the cover.

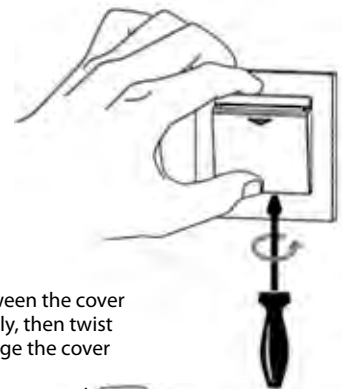

After the cover removed :

1. Insert a screwdriver between the surround and the wall surface carefully, then twist the screwdriver to dislodge the surround from the baseplate.
2. Use the other hand to support and remove the surround.

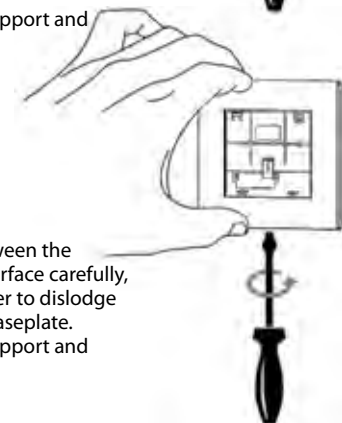

**ATTENTION :**  
Electrical installation must be carried out by a qualified electrician.

# B2000L KEYCARD SWITCH

## B2031EKT

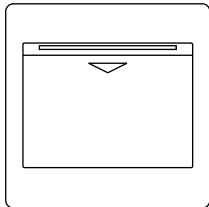

Keycard switch with indicator.

The recommended card size  
W x H x D : 85,5 x 54 x 0,9 mm

Voltage : 220 VAC, 50/60 Hz  
Load Rating : 16 A  
Dimension : 87 x 87 mm  
Mounting Centre : 60,3 mm

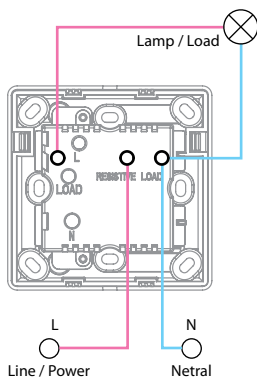

## B2031RFKT

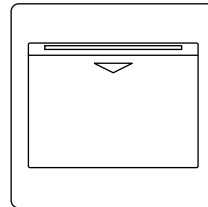

RFID keycard switch with indicator.

The recommended card size  
W x H x D : 85,5 x 54 x 0,9 mm

Voltage : 220 VAC, 50/60 Hz  
Load Rating : 16 A  
Dimension : 87 x 87 mm  
Mounting Centre : 60,3 mm  
RFID Standard : Mifare

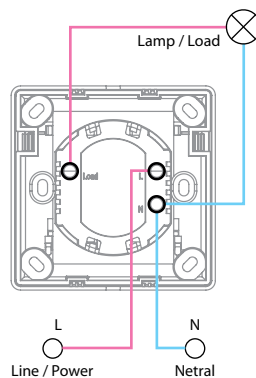

## MOUNTING INSTRUCTION

1. Align and place the baseplate on the wall box and then fasten the screw on both sides.

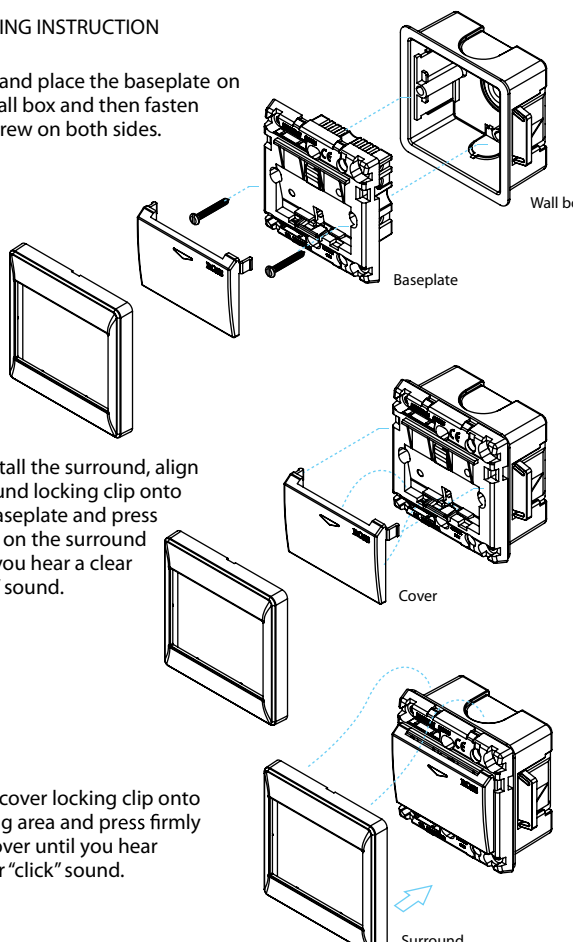

2. To install the surround, align surround locking clip onto the baseplate and press firmly on the surround until you hear a clear "click" sound.

3. Align cover locking clip onto locking area and press firmly the cover until you hear a clear "click" sound.

## REMOVING THE COVER

To remove the cover :

1. Insert a screwdriver between the cover and the surround carefully, then twist the screwdriver to dislodge the cover from the locking area.
2. Use the other hand to support and remove the cover.

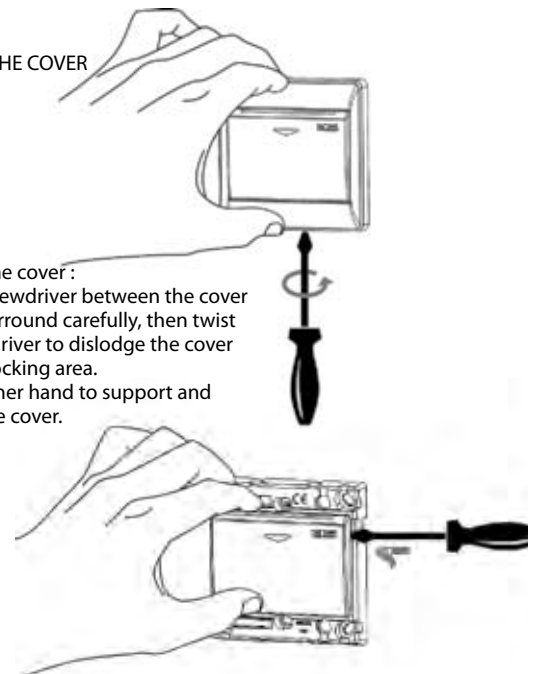

After the cover removed :

1. Insert a screwdriver between the surround and the wall surface carefully, then twist the screwdriver to dislodge the surround from the baseplate.
2. Use the other hand to support and remove the surround.

**ATTENTION :**  
Electrical installation must be carried out by a qualified electrician.

# B3000 KEYCARD SWITCH

## B3031EKT

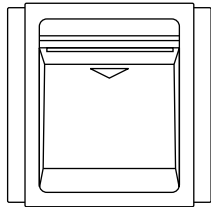

Keycard switch with indicator.

The recommended card size  
W x H x D : 85,5 x 54 x 0,9 mm

Voltage : 220 VAC, 50/60 Hz  
Load Rating : 16 A  
Dimension : 87 x 87 mm  
Mounting Centre : 60,3 mm

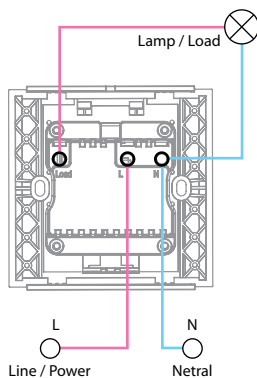

## B3031RFKT

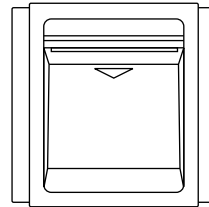

RFID keycard switch with indicator.

The recommended card size  
W x H x D : 85,5 x 54 x 0,9 mm

Voltage : 220 VAC, 50/60 Hz  
Load Rating : 16 A  
Dimension : 87 x 87 mm  
Mounting Centre : 60,3 mm  
RFID Standard : Mifare

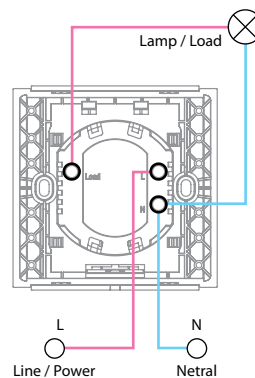

## MOUNTING INSTRUCTION

1. Align and place the baseplate on the wall box and then fasten the screw on both sides.

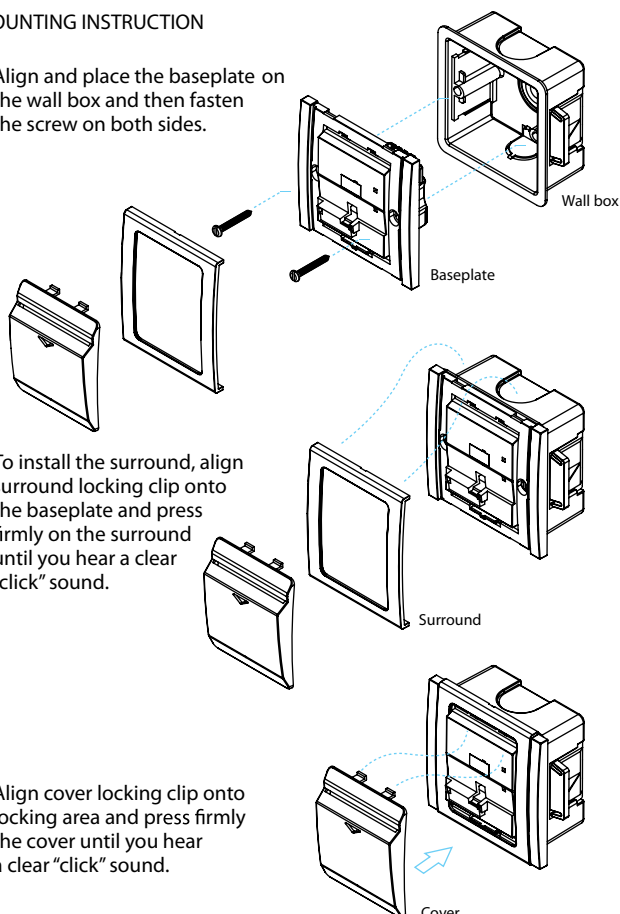

## REMOVING THE COVER

To remove the cover :

1. Insert a screwdriver between the cover and the surround carefully, then twist the screwdriver to dislodge the cover from the locking area.
2. Use the other hand to support and remove the cover.



After the cover removed :

1. Insert a screwdriver between the surround and the wall surface carefully, then twist the screwdriver to dislodge the surround from the baseplate.
2. Use the other hand to support and remove the surround.



**ATTENTION :**  
Electrical installation must be carried out by a qualified electrician.